

**STATE OF FLORIDA**  
**OFFICE OF THE GOVERNOR**  
***ECONOMIC DEVELOPMENT TRANSPORTATION FUND***

**AMENDMENT 2**

Amendment Number 2 made this 2 day of October, 2001, amends the Agreement (OT01-073) entered into on February 19, 2001, between the Office of Tourism, Trade, and Economic Development (OTTED) and Nassau County (County) on behalf of Mulch Manufacturing, Inc. (EDTF Business) and modified on August 24, 2001. A copy of Amendment #1 and the original agreement with exhibit are attached as "Exhibit A."

Whereas the parties to the Agreement desire to modify certain provisions relating to the Agreement;

Now, Therefore in consideration of the mutual promises and agreements contained herein, the parties agree as follows:

**The text of Section 2.0 of the Agreement is hereby stricken and shall be amended and shall now read:**

**2.0 TERM:** The term of this Agreement commenced upon execution of the original EDTF Agreement (February 19, 2001) and continues through August 29, 2003, unless terminated at an earlier date as provided herein. Only project costs incurred on or after the effective date of February 19, 2001, and on or prior to the termination date of this agreement are eligible for reimbursement.

**The text of Section 6.0(b) of the Agreement is hereby stricken and shall be amended and shall now read:**

(b) The County shall certify to OTTED that the EDTF Business referred to in Paragraph 1.0 above has secured the necessary permits, including but not limited to, building permits, and initiated construction of the facilities referenced. If the County fails to provide such certification to OTTED by December 21, 2001, OTTED may, at its discretion, terminate this Agreement;

**The text of Section 15.0 of the Agreement is hereby stricken and shall be amended and shall now read:**

**15.0 COMMENCEMENT:** Unless terminated earlier, the construction of the Project shall commence no later than January 31, 2002, and shall be completed on or before August 29, 2002. OTTED shall have the immediate option to terminate this Agreement should the County fail to meet either of the above-required dates.

**31.0 SIGNATORIES AUTHORITY:** By the execution hereof, the parties covenant that the provisions of this Agreement have been duly approved and signatories hereto are duly authorized to execute this Agreement.

**32.0 DUPLICATE ORIGINALS:** This Agreement is executed in duplicate originals.

**STATE OF FLORIDA  
EOG/OTTE**

**BY:** 

**DATE:** 10/2/01

**TITLE:** Director

**ATTEST:** 

**TITLE:** Incentive Coordinator

**NASSAU COUNTY**

**BY:**   
MARIANNE MARSHALL

**DATE:** September 24, 2001

**TITLE:** CHAIRMAN, BD. OF COUNTY COMMISSIONERS

**ATTEST:**   
J. M. "CHIP" OXLEY, JR.

**TITLE:** EX-OFFICIO CLERK

**Attachment:**

**Exhibit A – Previous Agreement and/or Amendment(s) with the Economic Development Transportation Fund Application**

E:\NCENTS\EDTF\MODIFY\01-modify-mrg-agr.doc

APPROVED AS TO FORM BY THE  
NASSAU COUNTY ATTORNEY:

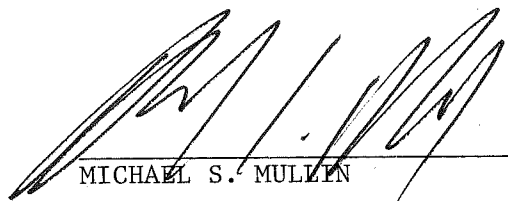
  
MICHAEL S. MULLEN

# **EXHIBIT A**

**STATE OF FLORIDA**  
**OFFICE OF THE GOVERNOR**  
***ECONOMIC DEVELOPMENT TRANSPORTATION FUND***

**AMENDMENT 1**

Amendment Number 1 made this 24 day of August, 2001, amends the Agreement (OT01-073) entered into on February 19, 2001, between the Office of Tourism, Trade, and Economic Development (OTTED) and Nassau County (County) on behalf of Mulch Manufacturing, Inc. (EDTF Business). A copy of the original agreement is attached as "Exhibit A."

Whereas the parties to the Agreement desire to modify certain provisions relating to the Agreement;

Now, Therefore in consideration of the mutual promises and agreements contained herein, the parties agree as follows:

**The text of Section 2.0 of the Agreement is hereby stricken and shall be amended and shall now read:**

**2.0 TERM:** The term of this Agreement commenced upon execution of the original EDTF Agreement (February 19, 2001) and continues through March 1, 2003, unless terminated at an earlier date as provided herein. Only project costs incurred on or after the effective date of February 19, 2001, and on or prior to the termination date of this agreement are eligible for reimbursement.

**The text of Section 6.0(b) of the Agreement is hereby stricken and shall be amended and shall now read:**

(b) The County shall certify to OTTED that the EDTF Business referred to in Paragraph 1.0 above has secured the necessary permits, including but not limited to, building permits, and initiated construction of the facilities referenced. If the County fails to provide such certification to OTTED by August 20, 2001, OTTED may, at its discretion, terminate this Agreement;



**The text of Section 15.0 of the Agreement is hereby stricken and shall be amended and shall now read:**

**15.0 COMMENCEMENT:** Unless terminated earlier, the construction of the Project shall commence no later than September 1, 2001, and shall be completed on or before March 1, 2002. OTTED shall have the immediate option to terminate this Agreement should the County fail to meet either of the above-required dates.



**31.0 SIGNATORIES AUTHORITY:** By the execution hereof, the parties covenant that the provisions of this Agreement have been duly approved and signatories hereto are duly authorized to execute this Agreement.

**32.0 DUPLICATE ORIGINALS:** This Agreement is executed in duplicate originals.

**STATE OF FLORIDA**  
**EOG/OTTED**

**BY:**   
**DATE:** 8/24/01  
**TITLE:** Director  
**ATTEST:**   
**TITLE:** Intervenor Coordinator

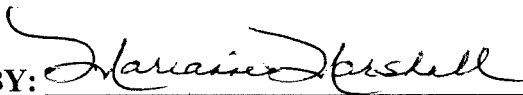
**NASSAU COUNTY**  
**BOARD OF COUNTY COMMISSIONERS**

**BY:**   
**DATE:** August 20, 2001  
**TITLE:** CHAIRMAN  
**ATTEST:**   
**TITLE:** EX-OFFICIO CLERK

**Attachment:**

**Exhibit A – Previous Agreement and/or Amendment(s) with the Economic Development Transportation Fund Application**

I:\NCENTS\EDTF\MODIFY\01-modify-mrg-agr.doc

Approved as to form by the  
Nassau County Attorney:

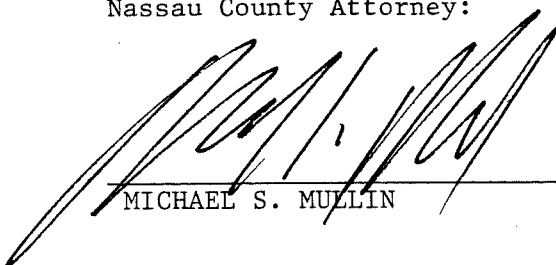
  
MICHAEL S. MULLIN

# **EXHIBIT A**



**STATE OF FLORIDA**  
**OFFICE OF THE GOVERNOR**  
***ECONOMIC DEVELOPMENT TRANSPORTATION FUND***

**AGREEMENT**

This Agreement (OT01-073) is entered into this 19<sup>th</sup> day of February, 2000, between the State of Florida Office of Tourism, Trade, and Economic Development (OTTED) and Nassau County (County) on behalf of Mulch Manufacturing, Inc. (EDTF Business).

OTTED has determined that the transportation project described in the Economic Development Transportation Fund (EDTF) Application, incorporated herein and attached as "Exhibit A" and hereinafter referred to as the "Project," is necessary to facilitate the economic development and growth of the State as contemplated by Section 288.063, Florida Statutes.

The County is prepared to complete the Project at an estimated total cost of \$594,000.00.

OTTED is prepared to provide \$594,000.00 toward the total project cost of construction of the transportation project described in Section 1.0.

In consideration of the mutual undertakings and agreements hereinafter set forth and agreed between the parties as follows:

**1.0 PROJECT DESCRIPTION:** The Project, identified as Project Number 00/0145A, is described as follows and is in connection with the location of facilities by the EDTF Business:

**Construct an approximately 1,800-foot rail spur to connect the EDTF Business site to the existing railway; and, construct an access road, approximately 1,000 feet, to connect the rail spur to U.S. Highway 301, along a 200-foot diameter cul-de-sac.**

**2.0 TERM:** The term of this Agreement shall commence upon execution and continue through September 30, 2002, unless terminated at an earlier date as provided herein. Only project costs incurred on or after the effective date of this agreement and on or prior to the termination date of the agreement are eligible for reimbursement.

**3.0 PARTIES:** The parties and their respective addresses for purposes of this Agreement are as follows:

STATE OF FLORIDA  
OFFICE OF THE GOVERNOR  
OFFICE OF TOURISM, TRADE, AND ECONOMIC DEVELOPMENT  
THE CAPITOL, SUITE 2001  
TALLAHASSEE, FLORIDA 32399-0001  
FAX: 850/487-3104

NASSAU COUNTY  
POST OFFICE BOX 456  
FERNANDINO BEACH, FLORIDA 32035  
FAX: (904) 321-5763

**4.0 NOTICES:** All notices pertaining to this Agreement shall be in writing and shall be transmitted either by personal hand delivery; United States Post Office, return receipt requested; or, overnight express mail delivery. Facsimile transmission or confirmed e-mail may be used if the notice is also transmitted by one of the preceding forms of delivery. The addresses set forth above for the respective parties shall be the places where notices shall be sent, unless prior written notice of change of address is given.

**5.0 ADMINISTRATORS:** The State EDTF Grant administrator is Wynnelle Wilson,  
Chief Analyst for Policy & Incentives. The County Agreement Administrator is  
\_\_\_\_\_. All approvals referenced in this agreement  
must be obtained in writing from the parties' agreement administrators or their designees.

**6.0 RELEASE OF FUNDS:** Project funds made available by OTTED shall not be released until the following have been satisfied:

(a) The County shall agree by resolution to accept future maintenance and other attendant costs occurring after completion of the Project for the portion of the Project on the County system and forward said resolution to OTTED;

(b) The County shall certify to OTTED that the EDTF Business referred to in Paragraph 1.0 above has secured the necessary permits, including but not limited to, building permits, and initiated construction of the facilities referenced. If the County fails to provide such certification to OTTED within 180 days of this contract's execution, OTTED may, at its discretion, terminate this Agreement;

(c) The County shall verify all invoices, statements or other related documents duly submitted to the County for pre-audit and approval by the County;

(d) The County shall certify that its adopted local government comprehensive plan is in compliance with Chapter 163, Part II, Florida Statutes, and that any amendments to the adopted plan related to the transportation Project or EDTF Business facility have been determined by the Department of Community Affairs to be in compliance with Chapter 163, Part II, Florida Statutes;

(e) The County shall provide to OTTED certification and a copy of appropriate documentation substantiating that all required right-of-ways have been obtained and meet the definition of right-of-way set forth in Section 334.03(22), Florida Statutes; and,

(f) Provide OTTED with written notification of either its intent to:

(i) Award the construction of the transportation project to the lowest and best bidder in accordance with applicable state and federal statutes, rules and regulations. The County shall then submit a copy of the bid tally sheet(s) and awarded bid contract, or

(ii) Construct the transportation project utilizing existing County employees, if the County can complete said project within the time frame in Section 15.0 of this Agreement.

**6.1 TRANSFER OF FUNDS:** Upon execution of this Agreement by OTTED and upon written request from the County, OTTED will transfer funds to the County to be applied toward direct Project costs on a quarterly basis consistent with project needs.

**6.2 INVESTMENT OF FUNDS:** Funds transferred to the County by OTTED shall be invested by the County until their actual expenditure, in such income or revenue producing investments as authorized by law for other County funds. All income, interest or other revenues obtained from such investment shall be considered funds of OTTED. The income, interest or other revenues shall be remitted to OTTED on a quarterly basis within fifteen (15) days of the close of the months March, June, September, and December, regardless of the month in which funds were received. Upon completion of the project, all remaining income, interest, or other revenues shall be returned to OTTED. All refund or interest checks shall be made payable to: **EOG/OTTED**, and mailed to the OTTED address in Section 3.0 of this Agreement; with the Project Number referenced and information that identifies the grant, interest period, amount of interest earned by account, name of depository, and interest rate. The documentation submitted to support interest earnings should include copies of bank or investment account statements, computational work sheets, etc.

**6.3 USE OF FUNDS:** Funds made available by OTTED pursuant to this Agreement shall be expended in a timely manner and solely for the purpose of the Project. No such funds shall be used for the purchase of any capital equipment, landscaping, mitigation planting, water and sewer lines, for any legal action against OTTED, for the administration of the project fund or costs associated with preparation of the application.

**7.0 LOBBYING:** Funds may not be used for the purpose of lobbying the Legislature, judicial branch, or any state agency, per Section 216.347, Florida Statutes.

**8.0 ASSURANCES:** As an inducement to the transfer of funds referred to in Paragraph 6.1 above, the County grants the assurances that, if initiated, the Project will be carried through to its completion and will not require the expenditure of any additional funds from OTTED. The County shall be liable for all cost overruns on the Project.

**9.0 DESIGN AND CONSTRUCTION STANDARDS:** The County agrees to design and construct the Project in accordance with standards promulgated by the Florida Department of Transportation (DOT) in accordance with Section 336.045, Florida Statutes, and to provide certification of same to OTTED upon completion of the Project. Such certification shall be provided by a professional engineer registered in Florida who shall certify that all design and construction for the Project meets minimum construction standards established by DOT pursuant to Section 336.045, Florida Statutes.

**10.0 MINORITY VENDORS:** The County is encouraged to utilize "minority business enterprises," as defined in Section 288.703, Florida Statutes, as subcontractors or sub-vendors when permitted under this Agreement and shall, report same to OTTED.

**11.0 ACCOUNTING, REPORTS AND AUDIT REQUIREMENTS:** The County agrees:

(a) To maintain books, records, documents and other evidence according to generally accepted governmental accounting principles, procedures and practices which sufficiently and properly reflect all costs of any nature incurred by the County in the performance of this Agreement and to retain said books, records, documents and other evidence for a period of three (3) years after termination of this Agreement.

(b) That aforesaid records, books, documents and other evidence shall be subject at all times to inspection, review or audit by state personnel of the Office of Auditor General, Office of Comptroller and other state personnel authorized by OTTED.

(c) To include these aforementioned audit and record keeping requirements in contracts and subcontracts entered into by the County with any party for work required in the performance of this Agreement.

(d) That three (3) months after the date of execution of this Agreement and every three (3) months thereafter, the County will provide OTTED with quarterly progress reports. Each quarterly report shall contain a narrative description of the work completed according to the project schedule; a description of any change orders executed by the County; a budget summary detailing planned expenditures versus actual expenditures; and identification of minority business enterprises used as contractors and subcontractors. Records of all progress payments made for work in connection with such transportation projects, and any change orders executed by the County and payments made pursuant to such orders, shall be maintained by the County in accordance with accepted governmental accounting principles and practices and shall be subject to financial audit as required by law.

(e) The County shall submit to OTTED a financial audit, pursuant to Section 288.063(8), Florida Statutes, within three (3) months of the Project's completion.

(f) In the event the County expends a total amount of State awards (i.e., State financial assistance provided to a recipient to carry out a State project) equal to or in excess of \$300,000 in any fiscal year of such receipt, the County shall have a State single or project-specific audit for such fiscal year in accordance with Chapter 215.97, Florida Statutes; applicable rules of the Executive Office of The Governor and the Comptroller; and Chapter 10.600, Rules of the Auditor General. In determining the State awards expended in its fiscal year, the County shall consider all sources of State awards, including State funds received from OTTED, except that State awards received by a non-state entity for Federal program matching requirements shall be excluded from consideration. However, if the County expends less than \$300,000 in State awards in its fiscal year, an audit conducted in accordance with the provisions of Chapter 215.97, Florida Statutes, is not required. In connection with the audit requirements, the County shall ensure that the audit complies with all requirements of Section 215.97, Florida Statutes, including submission of a reporting package to OTTED and the Auditor General.

(g) The County shall provide each sub-recipient of State awards information needed by the sub-recipient to comply with the requirements of Section 215.97, Florida Statutes. Pursuant to Section 215.97(6), Florida Statutes, the County shall review and monitor sub-recipient audit reports, and perform other procedures as specified in the agreement with the sub-recipient, which may include on-site visits. The County shall require that sub-recipients, as a condition of receiving State financial assistance, permit the independent auditor of the recipient, the State awarding agency, the comptroller, and the Auditor General access to the sub-recipient's

independent auditor's working papers as necessary to comply with the requirements of Section 215.97, Florida Statutes.

**12.0 TERMINATION REPORT:** Upon termination of this Agreement, the County will provide the following:

(a) Certification that the Project has been completed in compliance with the terms and conditions of this Agreement, and meets minimum construction standards established in accordance with Section 336.045, Florida Statutes.

(b) A report which shall specify (i) the total funds transferred to the County by OTTED pursuant to this Agreement; (ii) the total income, interest or other revenues obtained from the investment of said funds; (iii) the total direct Project costs paid from funds made available by OTTED pursuant to this Agreement; (iv) the balance of any unexpended Project funds; (v) the actual amount of the EDTF Business' capital investment, and, (vi) the actual number of permanent full-time jobs created by the EDTF Business.

**13.0 FOLLOW-UP REPORT:** Two (2) years after the EDTF Business has completed the construction associated with this Project, the County will provide OTTED with the actual number of new, permanent, full-time jobs created by the EDTF Business.

**14.0 INDEPENDENT CAPACITY:** The County shall act as an independent contractor and not as an employee of OTTED in the performance of this Agreement. To the extent permitted by law, the County covenants and agrees that it will indemnify and hold harmless OTTED and all of OTTED's officers, agents, and employees from any claim, loss, damage, cost, charge or expense arising out of any act, action, neglect or omission by the County during the performance of the contract, whether direct or indirect, and whether to any person or property to which OTTED, or said parties may be subject to, except that neither the County nor any of its



sub-contractors will be liable under this section for damages arising out of injury or damage to persons or property directly caused or resulting from the sole negligence of OTTED or any of its officers, agents or employees.

**15.0 COMMENCEMENT:** Unless terminated earlier, the construction of the Project shall commence no later than April 3, 2001, and shall be completed on or before October 1, 2001. OTTED shall have the immediate option to terminate this Agreement should the County fail to meet either of the above required dates.

**16.0 UNEXPENDED FUNDS:** Upon termination or expiration of this Agreement, any funds made available by OTTED pursuant to this Agreement but have not been expended at that time, shall be returned to OTTED. All investment earnings realized pursuant to paragraph 6.2 above shall be returned to OTTED.

**17.0 EXPENDITURES IN VIOLATION OF AGREEMENT:** Any Project funds made available by OTTED pursuant to this Agreement which are determined by OTTED to have been expended by the County in violation of this Agreement, other applicable law or regulation shall be promptly refunded in full to OTTED. Acceptance by OTTED of any documentation or certifications required or permitted to be filed by the County shall not constitute a waiver of OTTED's rights as the funding agency to verify all information at a later date by audit or investigation.

**18.0 TERMINATION OF AGREEMENT:** Either party may terminate this Agreement upon no less than 24 hours notice in writing delivered by certified mail, return receipt requested, or in person with proof of delivery. In the event the County fails to perform or honor the requirements and provisions of this Agreement, the County shall return funds in accordance with paragraphs 16.0 and 17.0 of this Agreement, within 30 days of the termination of this Agreement.

**19.0 TRAVEL:** There shall be no reimbursement for travel expenses exceeding the all-inclusive funds allocated in the Grant Agreement.

**20.0 MODIFICATION OF AGREEMENT:** In the event the County desires to modify any of the terms and conditions of this Agreement, the County shall make such request for modification in writing to OTTED at anytime during the term of this Agreement. However, where the request for modification relates to changes in the project commencement and/or project completion dates, such request must be received by OTTED prior to the expiration of the current commencement or project completion date. If the request for modification of the commencement or completion date is made after the expiration of such date, OTTED shall have the option to terminate this Agreement.

**21.0 ATTORNEY FEES:** Unless authorized by law and agreed to in writing by the OTTED, OTTED will not be liable to pay attorney fees, interest, or cost of collection.

**22.0 WAIVER:** The failure of either party to this Agreement to object to or to take affirmative action with respect to any conduct of the other which is in violation of the terms of this Agreement shall not be construed as a waiver of the violation or breach, or of any future violation, breach or wrongful conduct.

**23.0 ENTIRE AGREEMENT:** This instrument embodies the entire agreement of the parties. There are no provisions, terms, conditions, or obligations other than those contained in this agreement; and this agreement supersedes all previous communication, representation, or agreement, either verbal or written, between the parties. No amendment will be effective unless reduced to writing and signed by the parties.

**24.0 SEVERABILITY:** If any term or provision of the agreement is found to be illegal and unenforceable, the remainder of the agreement shall remain in full force and effect and such term or provision shall be deemed stricken.

**25.0 STRICT COMPLIANCE WITH LAWS:** The County agrees that all acts to be performed by it in connection with this agreement shall be performed in strict conformity with all applicable laws and regulation of the State of Florida.

**26.0 NON-DISCRIMINATION:** The County will not discriminate against any employee employed in the performance of this agreement, or against any applicant for employment because of age, race, creed, color, handicap, national origin, or sex. The County shall insert a similar provision in all subcontracts for services by this Agreement.

Pursuant to Section 287.134, Florida Statutes, an entity or affiliate who has been placed on the discriminatory vendor list may not submit a bid on a contract to provide any goods or services to a public entity, may not submit a bid on a contract with a public entity for the construction or repair of a public building or public work, may not submit bids on leases of real property to a public entity, may not be awarded or perform work as a contractor, supplier, subcontractor, or consultant under a contract with any public entity, and may not transact business with any public entity.

**27.0 AVAILABILITY OF FUNDS:** The State of Florida's performance and obligation to pay under this agreement are contingent upon an appropriation by the Legislature. In the event that the state funds on which this agreement are dependent are withdrawn, the agreement is terminated and the State has no further liability to the County beyond that already incurred by the termination date. In the event of a State revenue shortfall, the total grant may be reduced accordingly.

**28.0 PUBLIC ENTITY CRIME:** A person or affiliate who has been placed on the convicted vendor list following a conviction for a public entity crime may not submit a bid on a contract to provide any goods or services to a public entity, may not submit a bid on a contract with a public entity for the construction or repair of a public building or public work, may not submit bids on leases of real property to a public entity, may not be awarded or perform work as a contractor, supplier, subcontractor, or consultant under a contract with any public entity, and may not transact business with any public entity in excess of the threshold amount provided in Section 287.017 for CATEGORY TWO for a period of 36 months from the date of being placed on the convicted vendor list.

**29.0 UNAUTHORIZED ALIENS:** OTTED will consider the employment of unauthorized aliens by any contractor a violation of Section 274A(e) of the Immigration and Nationalization Act. Such violation shall be cause for unilateral cancellation of this contract.

**30.0 PUBLIC RECORDS:** OTTED may unilaterally cancel this Agreement for refusal by the County to allow public access to all documents, papers, letters, or other material subject to the provisions of Chapter 119, Florida Statutes, and made or received by the County in conjunction with this agreement.

**31.0 SIGNATORIES AUTHORITY:** By the execution hereof, the parties covenant that the provisions of this Agreement have been duly approved and signatories hereto are duly authorized to execute this Agreement.

**32.0 DUPLICATE ORIGINALS:** This Agreement is executed in duplicate originals.

STATE OF FLORIDA  
EOG/OTTE

NASSAU COUNTY

BY: 

BY: 

DATE: 2/19/01

DATE: 2-12-01

TITLE: Director

TITLE: Chairman, Nassau County Board of County Commissioners

ATTEST: Cheryl Clark

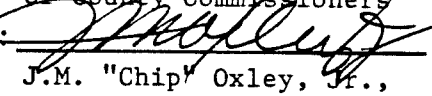
ATTEST:   
J.M. "Chip" Oxley, Jr.,

TITLE: Incentives Support

TITLE: Ex-Officio Clerk

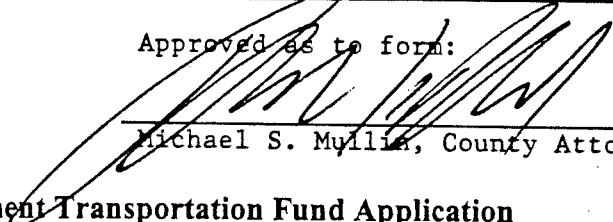
Approved as to form:  
  
Michael S. Mullin, County Attorney

Attachment:

Exhibit A -- Economic Development Transportation Fund Application

# **EXHIBIT A**

**STATE OF FLORIDA  
ECONOMIC DEVELOPMENT TRANSPORTATION FUND  
APPLICATION**

**NASSAU COUNTY, FLORIDA**

---

**Unit of Government or Public Authority ("Applicant")**

*on behalf of*

**MULCH MANUFACTURING, INC.**

---

**Business Name**

FOR EFI USE ONLY	
<u>9/14/02</u> Date Received	<u>10/16/02</u> Date Completed
<u>00/0145A</u> Project Number	

**Submit Application To:  
Enterprise Florida  
Attn: Alberta Simmons  
Economic Development Transportation Fund Program  
The Atrium Building, Suite 201  
325 John Knox Road  
Tallahassee, Florida 32303  
Telephone: (850) 922-8737 Fax: (850) 922-9595**

**ECONOMIC DEVELOPMENT TRANSPORTATION FUND APPLICATION  
OFFICE OF TOURISM, TRADE, AND ECONOMIC DEVELOPMENT**

Applicants are advised that this application must be submitted in accordance with the provisions of Florida Statutes, Section 288.063, and the Office of Tourism, Trade, and Economic Development's Economic Development Transportation Fund Guidelines.

**I. APPLICANT**

Government Applicant: NASSAU COUNTY, FLORIDA

Government Federal Employee Identification Number: 59-04-00595

Name of Primary Contact: Jack D'Amato

Title: Public Works Director

Address: P.O. Box 456

Fernandina Beach Florida 32035

(City) (State) (Zip)

Telephone: (904) 321-5760, (800) 264-2065 Fax: (904) 321-5763

**II. COMPANY PROVIDING EMPLOYMENT (only one company may be listed)**

Company: Mulch Manufacturing Inc.

Primary Contact: Mr. John W. Spencer

Title: President

Address: 6747 Taylor Road S.W.

Reynoldsburg Ohio 43068

(City) (State) (Zip)

Telephone: (614) 864-4004 Fax: (614) 864-1946

Principal Business Activity: Producing pine, cypress and hardwood mulch

SIC Code Number: \_\_\_\_\_

Type of Facility: New ( ) Existing ( ) Expansion (X)

Estimated Time for Construction: Rail Spur and New Public Road will commence by November 2000, with anticipated completion by May 1, 2001.

Estimated Square Feet of Facility: Approximately 10,000 square feet of new building will be constructed within a twelve to eighteen month time period.



Full-time Employment Generated/Retained:

New 100 Retained 110

(Grant request should not exceed \$5,000 per job. Grants of up to \$7,500 per job may be approved when the project occurs in an economically distressed community and a further waiver of this guideline may be granted if at least two of the conditions listed in Section IV have been met and documented.)

New Capital Investment Generated: \$5,000,000

Briefly Describe the Facility (New or Existing) or the Expansion.

The existing facility has a present capital input of about \$8,000,000. The proposed long term expansion of our current facilities requires the expenditure of about \$5,000,000 in capital funds. The first item of business will be clearing and upgrading the property. We then intend to erect a 10,000 square foot building. At the same time we will be buying and installing equipment for our expanded operation. This will include log handling and milling equipment, tractor-trailers, wheeled equipment and additions to our sawmill.

The next step is to upgrade our sawmill allowing us to double production to our customer base. Once this is completed our two out-of-state partner companies intend to relocate to this Nassau County facility. One company is a log home manufacturer from Alabama. The other partner is a fence manufacturer currently located in Southern Georgia. This new facility will offer maximum utilization of both equipment and raw materials.

Our final process will be extensive modifications to our lumber operation. This will allow us to produce a high-grade lumber product, to customers both in and out of Florida. When all this work is completed within two to three years, the location will have approximately doubled in size and employment.

III. TRANSPORTATION (Attach a rough site plan with facility in relation to the requested transportation improvements.)

A. Briefly describe the transportation problem which is an impediment to the company described above and give its importance to the company's decision.

The major transportation problem is the need to import raw materials and ship

finished products by rail. Truck transportation is too expensive. In order to accomplish our proposed expansion we must have a rail spur. This spur will connect to the CSX Railroad allowing us to receive raw materials and ship out finished goods. This in turn will enable us to expand our operations as well as making it possible for two additional companies to locate on this site. The spur will also provide opportunities to utilize these facilities for new business ventures from within the company or from other companies in Nassau County.

The spur will also require the construction of a public road to allow traffic to and from the spur to State Road 301.

B. Briefly describe the transportation project which will alleviate the transportation problem.

The construction of an 1,800 foot rail spur track and also the construction of a 1,000 foot public road with a 200 foot diameter cul-de-sac from the rail spur to State Road 301. Building an 1800 foot spur track from the CSX main line onto this property will allow Mulch Manufacturing and our partner companies to load and unload railcars with both raw material and finished product.

C. Estimated Cost of the Transportation Project:

Construction of Public Road:	<u>\$ 247,500.00</u>
Design & Engineering Public Road:	<u>\$ 16,870.00</u>
Construction of Rail Spur:	<u>\$ 247,500.00</u>
Design & Engineering Rail Spur:	<u>\$ 74,664.00</u>
<b>TOTAL COST:</b>	<b><u>\$ 594,000.00</u></b>

\*May be used as matching dollars if acquisition is required from a third party in order to construct the transportation facility.

D. Transportation Project Funding Sources:

City:	<u>\$ 0.00</u>
County:	<u>\$ 0.00</u>
Company:	<u>\$ 0.00</u>

#EDTF04 (effective 07/99)

Post-it® Fax Note	7671	Date	10-13-00	# of Pages	2
Olberta Simmons		From Gus Rappold			
Co./Dept.		Co.			
Phone #		Phone #			

Request from the Economic Development Transportation Fund  
(\$2,000,000 maximum): \$ 594,000.00

TOTAL COST: \$ 594,000.00

(NOTE: Must add up to Total Cost in C. above)

E. Estimated time for construction: 3 to 6 Months.

**IV. PROJECT LOCATION**

- A. Located in an Enterprise Zone?  Yes  No
- B. Located in the Target Area of a Community Development Corporation?  Yes  No
- C. Located in a WAGES deficiency area?  Yes  No
- D. Located in a REDI County?  Yes  No
- E. County population of 75,000 or less?  Yes  No
- F. City population of 10,000 or less?  Yes  No
- G. City population over 10,000 but less than 20,000?  Yes  No

**V. SELECTED ECONOMIC INDICATIONS**

- A. Unemployment Rate: April, 2000 - 3.8%  
Information Source: Florida Department of Labor
- B. Per Capita Income: 1997 - \$24,045  
Information Source: Reg. Econ. Information System, U.S. Dept. of Commerce
- C. Poverty Rate: \_\_\_\_\_  
Information Source: \_\_\_\_\_

**VI. OTHER CONSIDERATIONS**

- A. Is the adopted local government comprehensive plan for the jurisdiction in compliance with Chapter 163, Part II, Florida Statutes?  Yes  No  
If not, what is the expected time frame for compliance? \_\_\_\_\_
- B. What is the Future Land Use Map designation for the business facility state?  
Industrial
- C. Are the transportation project and business facility consistent with the adopted local government comprehensive plan?  Yes  No

\*EDTF04 (effective 07/99)

If not, describe the inconsistency and give the time frame for amending the plan:

---

---

D. Does construction of the business facility trigger concurrency requirements other than for transportation facilities?  Yes  No

If so, explain:

---

---

E. Does construction of the business facility trigger concurrency requirements for transportation facilities?  Yes  No

If yes, what transportation management alternatives have been considered?

**Use of trucks to carry in raw materials and export finished product to rail.**

---

F. Does the adopted plan include an Economic Development Element?

Yes  No

G. Is the applicant's transportation project linked to other publicly funded economic development programs? If so, how does it further those efforts?

No

---

---

---

H. Will low to moderate income workers be eligible for employment within this facility?

Yes  No

If not, why not?

---

---

---

I. What role will the transportation project play in the decision of the business to locate, expand, or remain in this state?

**This transportation project is imperative to the corporate decision to remain in Florida. Any other transportation alternative would be too expensive for the movement of raw materials and finished product.**

J. Is there competition for this project?  YES  NO (Check all that apply.)

✓ State(s) Louisiana; Georgia; \_\_\_\_\_

Incentive(s): Site with existing rail spur, Tax Credit, Workforce Training

Country(ies) \_\_\_\_\_; \_\_\_\_\_; \_\_\_\_\_

Incentive(s): \_\_\_\_\_

Community(ies) \_\_\_\_\_; \_\_\_\_\_; \_\_\_\_\_

Incentive(s): \_\_\_\_\_

**VII. PROJECT INFORMATION**

Location of Project (Road Number):

U.S. \_\_\_\_\_ State 301 County \_\_\_\_\_ City \_\_\_\_\_

Party responsible for maintenance and upkeep:

State \_\_\_\_\_ County X City \_\_\_\_\_ Other \_\_\_\_\_

(If more than one is applicable, please indicate.)

Total Length of Project: 1/2 mile(s)

Brief Description of Project: The construction of an 1,800 foot rail spur track with and the construction of a 1,000 foot public access road with a 200 foot diameter cul-de-sac from the new rail spur to State Road 301.

Is there an alternative that would provide more cost effective access to the project?

\_\_\_\_\_ Yes  No

Are there any additional traffic impacts?

Yes \_\_\_\_\_ No

If yes, does the project provide for additional impact?

\_\_\_\_\_ Yes  No

If no, please explain: Additional traffic will be added to State Road 200

(U.S. 301). Capacity is available on the existing roadway. FDOT plans to widen the roadway in the near future.

**VIII. TRAFFIC IMPACTS FOR PROJECTS INVOLVING STATE HIGHWAYS ONLY**

1. Traffic generation estimates (in number of vehicles daily):
 

Number of Cars <u>614</u>	Number of Trucks <u>30</u>
---------------------------	----------------------------
  
2. AM Peak Hour 7:00 a.m. to 8:00 a.m.—Indicate Number of:
 

Inbound Cars <u>77</u>	Inbound Trucks <u>4</u>
Outbound Cars <u>29</u>	Outbound Trucks <u>4</u>
  
3. PM Peak Hour 3:00 p.m. to 4:00 p.m.—Indicate Number of:
 

Inbound Cars <u>48</u>	Inbound Trucks <u>4</u>
Outbound Cars <u>59</u>	Outbound Trucks <u>4</u>

**IX. SIGNATURE:** If this application is for a city road, the city must agree to maintain the road. If a county road is involved, the county must agree to maintain the road. This will be stipulated in all contracts involving expenditure of the Economic Development Transportation Fund. DOT form, letter from applicant, letter from the benefiting company and a map showing the relationship of the facility to the transportation project must accompany this application.

Please type: Nick Deonas  
 (Name)  
Chairman, Board of County Commissioners  
 (Title)

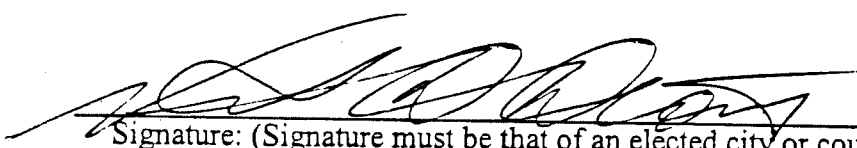
  
 Signature: (Signature must be that of an elected city or county official)

Specific Authority 288.063, 120.53 (1) (a), F. S.  
 Laws Implemented 288.063, 120.53 (1) (a), F. S.

#EDTF04 (effective 07/99)

OFFICE OF TOURISM, TRADE, AND ECONOMIC DEVELOPMENT  
ECONOMIC DEVELOPMENT TRANSPORTATION PROJECT  
FOR SUBMISSION TO YOUR DOT DISTRICT SECRETARY'S OFFICE

X DOT TRANSPORTATION PROJECT CONSTRUCTION COST ESTIMATE

Based on information provided with this application:

Estimated cost of construction:	\$	450,000.00	:
Estimated cost of right-of-way:	\$	N/A	:
Estimated cost of design and engineering:	\$	90,000.00	:

Has design and engineering been completed?  Yes  No

Was cost overrun considered in total cost?  Yes  No

If yes, how much? 5% \_\_\_\_\_

Is design in accordance with DOT specifications? \_\_\_\_\_

How many days estimated for completion? 210 \_\_\_\_\_

DOT Comments: Estimate based on information received from Nassau County.  
\_\_\_\_\_  
\_\_\_\_\_

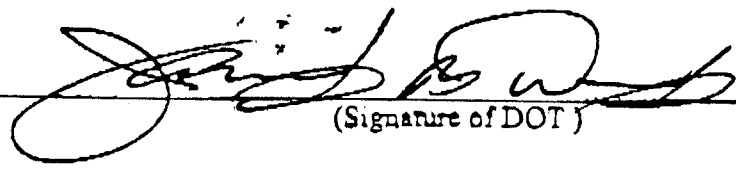

\_\_\_\_\_  
(Signature of DOT)

The signature of FDOT only attests to EDTF transportation project cost estimates and does not commit FDOT to automatically approve any permits associated with this project.



STATE OF FLORIDA  
**DEPARTMENT OF COMMUNITY AFFAIRS**

*"Dedicated to making Florida a better place to call home"*

JEB BUSH  
Governor

STEVEN M. SEIBERT  
Secretary

October 13, 2000

Ms. Alberta Simmons, Program Director, EDTF  
Enterprise Florida  
The Atrium Building  
325 John Knox Road, Suite 201  
Tallahassee, Florida 32303

Dear Ms. Simmons:

The Office of Tourism, Trade, and Economic Development requested that the Department of Community Affairs review and provide comments on the Economic Development Transportation Fund (EDTF) application from Nassau County on behalf of Mulch Manufacturing Inc.

The Department reviews EDTF applications for consistency with the following program areas: housing and community development, community planning at both the state and local levels, coastal management and emergency management.

Based on our review, the Department did not find any discrepancies with the grant application. If you have any questions, please contact Ms. Cherie Trainor at 414-5495. Thank you.

Sincerely,

Ralph Cantral, Executive Director  
Florida Coastal Management Program

RC/ct

cc: Mr. Jack D'Amato, Public Works Director, Nassau County  
Mr. John W. Spencer, President, Mulch Manufacturing Inc.

2555 SHUMARD OAK BOULEVARD • TALLAHASSEE, FLORIDA 32399-2100  
Phone: 850.488.8466/Suncom 278.8466 FAX: 850.921.0781/Suncom 291.0781  
Internet address: <http://www.dca.state.fl.us>

CRITICAL STATE CONCERN FIELD OFFICE  
2796 Overseas Highway, Suite 212  
Marathon, FL 33050-2227  
(850) 486-4742

COMMUNITY PLANNING  
2555 Shumard Oak Boulevard  
Tallahassee, FL 32399-2100  
(850) 488-2356

EMERGENCY MANAGEMENT  
2555 Shumard Oak Boulevard  
Tallahassee, FL 32399-2100  
(850) 413-0969

HOUSING & COMMUNITY DEVELOPMENT  
2555 Shumard Oak Boulevard  
Tallahassee, FL 32399-2100  
(850) 486-7956





**NASSAU COUNTY**  
**BOARD OF COUNTY COMMISSIONERS**  
P.O. Box 1010  
Fernandina Beach, Florida 32035-1010

Nick Deonas  
David C. Howard  
Pete Cooper  
Floyd L. Vanzant  
Marianne Marshall

Dist. No. 1 Fernandina Beach  
Dist. No. 2 Fernandina Beach  
Dist. No. 3 Yulee  
Dist. No. 4 Hilliard  
Dist. No. 5 Callahan

October 12, 2000

JOSEPH M. "Chip" OXLEY, JR.  
Ex-Officio Clerk

MICHAEL S. MULLIN  
County Attorney

WALTER D. GOSSETT  
County Coordinator

Ms. Alberta Simmons  
Enterprise Florida  
Economic Development Transportation Fund Program  
The Atrium Building, Suite 201  
325 John Knox Road  
Tallahassee, FL 32303

RE: Economic Development Transportation Fund Program Grant  
Request - Mulch Manufacturing, Inc., Crawford  
Industrial Park, Nassau County, Florida - Addendum to  
Application

Dear Ms. Simmons:

This letter is an addendum to Nassau County's letter of August 30, 2000, supporting the application of Mulch Manufacturing, Inc., for Economic Development Transportation Fund Program monies to support the retention and expansion of their operation in Nassau County.

This transportation project, which includes a rail spur and a public road, has been re-estimated by DOT. Their estimate is a total of \$540,000.00 including a five percent (5%) cost overrun. However, it would be prudent to increase the size of the cost overrun by another ten percent (10%) for a total of \$594,000.00. The reason for this is the potential additional costs related to unknown factors that may affect the rail spur construction and the possibility of wetlands affecting the right-of-way for the public road through the site.

(904) 225-2810 Board Room; 321-5703, 879-1029, (800) 958-3496

*An Affirmative Action / Equal Opportunity Employer*

Ms. Alberta Sim  
October 12, 2000  
Page 2

Nassau County continues to support the improved public facilities for the use of Mulch Manufacturing, Inc., and the other companies that may locate in the Crawford Industrial Park area.

Sincerely yours,

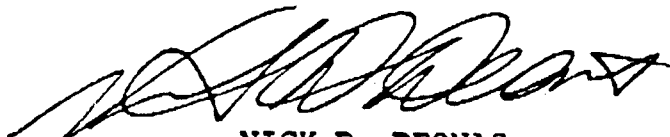

NICK D. DEONAS

NDD/am

Cc: Ken Willette, Nassau county Economic Development Board  
Ralph Spencer, Mulch Manufacturing, Inc.

f3/enterprise-012



**Mulch Manufacturing, Inc.**

6747 Taylor Road S.W.  
Reynoldsburg, Ohio 43068-9649  
(614) 864-4004

---

Oct. 11, 2000

Ms. Alberta Simmons  
Manager Business Retention and Recruitment  
Enterprise Florida  
Economic Development Transportation Fund Program  
The Atrium Building, Suite 201  
325 John Knox Road  
Tallahassee, Florida 32303

Re: Mulch Manufacturing Inc. Expansion Plan for Callahan, Florida  
Plant- Public Access Road Requirement

Dear Ms. Simmons:

As part of our overall expansion plan at our Callahan facility we will need a public road to allow access from State Route 301 to the proposed rail spur. This road will give ourselves and others the ability to transport products to and from the spur.

Considering the location of the wetlands between our plant and the new rail spur a public road from the spur to Route 301 will provide the route for us to move between our plant and the rail.

Thank you for your assistance in this matter.

Sincerely yours,

John W. Spencer  
President



Jeb Bush  
Governor

# Department of Environmental Protection

Marjory Stoneman Douglas Building  
3900 Commonwealth Boulevard  
Tallahassee, Florida 32399-3000

David B. Struhs  
Secretary

October 11, 2000

Ms. Alberta Simmons  
Enterprise Florida/Economic Development Transportation Fund Program  
The Atrium Building, Suite 201  
325 John Knox Road  
Tallahassee, Florida 32303

RE: EDTF Application on Behalf of Mulch Manufacturing Inc., Nassau County

Dear Ms. Simmons:

The Department of Environmental Protection has reviewed the above referenced Economic Development Transportation Fund (EDTF) application form, which involves constructing an access road to a proposed rail spur and constructing a rail spur from the CSX railroad line to the company's site. We have no comments at this time.

We appreciate the opportunity to provide comments on the proposed project. If I may be of further assistance, please contact me at (850) 487-2231. Thank you.

Sincerely,

Lindy Broz

Legislative and Governmental Affairs

/lmb

EDTF/Nassau/MulchMfg

"More Protection, Less Process"

Printed on recycled paper.



# Florida Department of Transportation

JEB BUSH  
GOVERNOR

605 Suwannee Street  
Tallahassee, Florida 32399-0450

THOMAS F. BARRY, JR.  
SECRETARY

October 10, 2000

Ms. Wynnelle Wilson, Economic Development Incentives Coordinator  
Office of Tourism, Trade, and Economic Development  
Executive Office of the Governor  
The Capitol  
Tallahassee, Florida 32399-2000

Subject: Economic Development Transportation Fund (EDTF) Project for Nassau County  
/Mulch Manufacturing, Inc.

Dear Ms. Wilson:

The Department of Transportation has reviewed the subject project application for consistency with the Department's policies, plans and standards. Based upon the information provided in the application, the project does not appear to adversely impact the State Highway System; however, permitting may be required for connections to U.S. 301 or any work to be done on State right of way.

Upon finalization of the project plans, the applicant should contact the following person to determine what requirements must be met before construction can begin:

Ms. Carol Wright  
Florida Department of Transportation  
Jacksonville Urban Office  
Post Office Box 6669  
Jacksonville, Florida 32236  
Phone Number: (904) 360-5610

If you have any questions, please contact Sandra Whitmire at 414-4812. Thank you.

Sincerely,

for Ysela Llort  
State Transportation Planner

YL:sw

cc: Alberta Simmons  
James Dees  
Carol Wright  
Ward Swisher



**NASSAU COUNTY**  
**BOARD OF COUNTY COMMISSIONERS**  
P.O. Box 1010  
Fernandina Beach, Florida 32035-1010

Nick Deonas  
David C. Howard  
Pete Cooper  
Floyd L. Vanzant  
Marianne Marshall

rec'd  
9/11/00  
Dist. No. 1 Fernandina Beach  
Dist. No. 2 Fernandina Beach  
Dist. No. 3 Yulee  
Dist. No. 4 Hilliard  
Dist. No. 5 Callahan

August 30, 2000

Enterprise Florida  
Attn: Alberta Simmons  
Economic Development Transportation Fund Program  
The Atrium Building, Suite 201  
325 John Knox Road  
Tallahassee, FL 32303

JOSEPH M. "Chip" OXLEY, JR.  
Ex-Officio Clerk

MICHAEL S. MULLIN  
County Attorney

WALTER D. GOSSETT  
County Coordinator

Re.: Economic Development Transportation Fund Program Grant Request –  
Mulch Manufacturing, Inc., Crawford Industrial Park, Nassau County, Florida

To Whom It May Concern:

Mulch Manufacturing, Inc. is considering an expansion of their operation in Nassau County. For this to be economically feasible they have requested the County's assistance through Nassau County applying for a grant in the amount of \$539,664 to construct a 1,800' rail spur track and a 1,000' public road with a 200' diameter cul-de-sac which will service their proposed new plant.

This transportation project is not presently scheduled by Nassau County for construction at any time in the future and certainly not within Mulch Manufacturing, Inc.'s desired time frame.

The estimated new capital investment by Mulch Manufacturing, Inc. is \$5,000,000.

A reasonable estimate of the Mulch Manufacturing, Inc. projected employment to be created is 100 workers with another 110 workers to be retained.

Mulch Manufacturing, Inc. is in a position where they desire to consolidate their operations with two out-of-state partner companies. The consolidation could in any one of their present other out-of state locations. However, through a \$539,664 grant from the Economic Development Transportation Fund Program Nassau County will build a rail spur and public road to assist by providing Mulch Manufacturing with an efficient and productive system to unload and load rail cars carrying raw materials and finished product. The construction of these public transportation facilities offers Mulch the economic impetus needed to locate their combined operation in Nassau County, Florida.

Sincerely yours,

Nick Deonas  
Chair,  
Board of County Commissioners

(904) 225-2610 Board Room; 321-5703, 879-1029, (800) 958-3496

*An Affirmative Action / Equal Opportunity Employer*



**Mulch Manufacturing, Inc.**

6747 Taylor Road S.W.  
Reynoldsburg, Ohio 43068-9649  
(614) 864-4004

---

June 26, 2000

Mr. Kenneth J. Willette  
Executive Director  
Nassau County Economic Development Board  
1890 South 14<sup>th</sup> Street, Suite E  
Fernandina Beach, Fl. 32034

Dear Ken:

As we have discussed many times in the past several weeks we at Mulch Manufacturing Inc. have very ambitious plans for expansion in Nassau County. This of course is predicated on our ability to fiscally accomplish all the things this expansion will require. Which will include additional real estate, buildings, equipment, and property improvements. As you know we have already expended substantial capital on a new sawmill and associated machinery.

Our long-term plan will require us to spend an additional \$ 5,000,000 to reach our goals. This is all being done to allow us to greatly expand and diversify our Callahan operation.

In order to accomplish this new expansion, we will need an 1,800-foot rail spur capable of receiving a large number of cars. This will allow us to receive the logs which are necessary for our expanded operation. These logs will be coming from several sources. The logs will be used in making mulch, lumber, fencing and log home components. The latter two operations will be new companies locating in the county. Both of these companies would relocate from other states. As you can imagine getting these projects off the ground requires a tremendous amount of effort and resources on our part.

The other use for this spur will be to ship out various finished products and local raw materials to customers both in and out of the state.

---

We are asking Nassau County to help us with these opportunities. Specifically, we are asking for help in the form of a grant to pay for the rail spur we require to make these projects happen. The benefits for the county are obvious; an expanded business base in the county, an increase in employment both at Mulch Manufacturing and the new industries, an expansion of the CSX presence in the county, and an increase in the county tax base.

The downside of course would be just the opposite. We would have to look at other states to expand our operations. This would entail a reduction or possible elimination of our Callahan plant and the ensuing impact on the community. Both Louisiana and Georgia have already expressed an interest and are offering economic incentives. Both are being given consideration.

We hope, with your help we will be able to remain in Nassau County. Mulch Manufacturing is prepared to make a major commitment to this expansion but we need your help. Thank you in advance for your consideration.

Very Truly Yours,

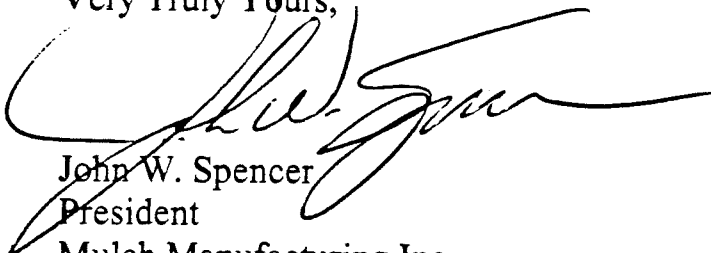

John W. Spencer  
President  
Mulch Manufacturing Inc.

CC: James Crawford, CSX Industrial Development

---



**Mulch Manufacturing, Inc.**  
**PROJECT PLAN**  
**for the**  
**Callahan, Florida Plant expansion**

April 5, 2000

John W. Spencer, President  
And  
Ralph T. Spencer, Vice President

Mulch Manufacturing, Inc.  
6747 Taylor Road S.W.  
Reynoldsburg, OH 43068  
(614) 864-4004

State Road 301 South  
P.O. Box 4014  
Callahan, FL 32011  
(904) 879-2180

The contents of this document are CONFIDENTIAL and can not be released to anyone without the expressed written permission from an officer of Mulch Manufacturing, Inc.

# BACKGROUND

Mulch Manufacturing consists of three production locations; One in central Ohio, one in Callahan, Florida and one in Madison, Florida. The largest production facility is in Callahan, Florida which produces five types of pine mulch, three types of Cypress mulch, hardwood mulch, recycled wood mulch, soil products and a sawmill that produces lumber products.

The customer base for Mulch Manufacturing is largely concentrated East of the Mississippi and consists of convenience stores, mass merchandisers such as Lowe's, Home Depot, Meijers, Franks, etc.; landscapers and retail outlets. The majority of this product is produced in Callahan, Florida and shipped into the markets by rail into one of eighteen holding locations or directly to the customer. Our largest selling product is Cypress mulch and we have nearly a 30% market share within our marketing area with this product. Our total annual sales is approximately \$30 Million.

The operation began in 1985 in Columbus, Ohio as a Cypress only plant addressing the Ohio marketplace. This was expanded in 1989 to include a new plant in Florida with an increased product line. The Florida location made it possible to economically address a larger market area by using rail to reach most all of the larger metropolitan areas east of the Mississippi river. Pine products were added in 1992, recycled colored mulch was added in 1998 and soil products were added in 1999. A full scale Cypress sawmill was built in 1998 and expanded in 1999.



Figure 1 Mulch Manufacturing mulch plant and sawmill located in Nassau county, Florida.



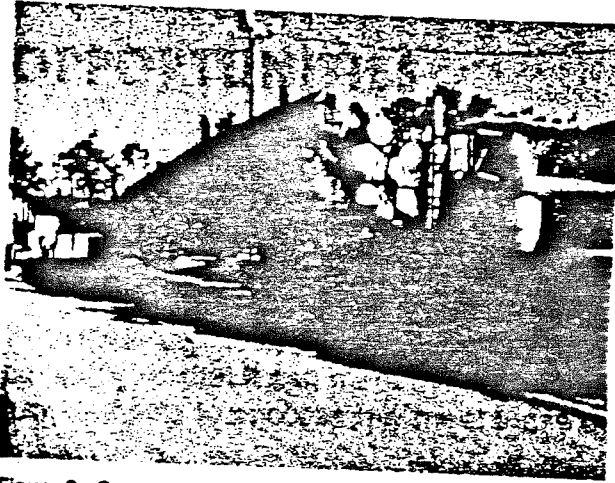

Figure 2 Cypress logs arriving by truck at the Callahan, Florida plant

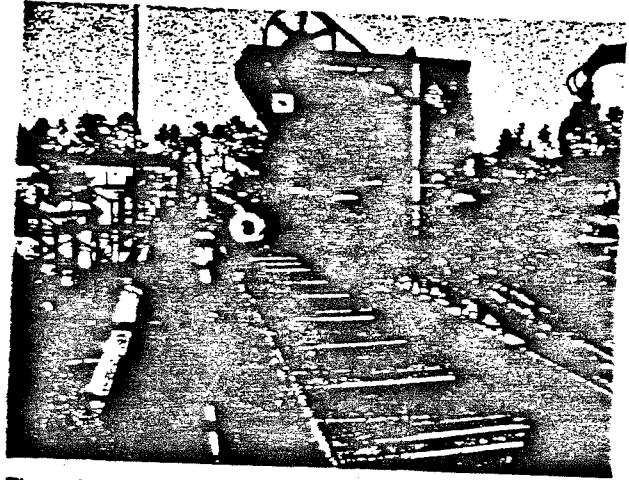

Figure 3 Sawmill operation



Figure 4 Colored mulch production facility

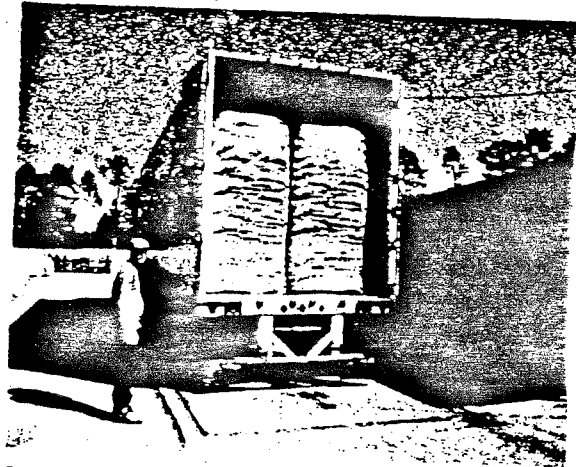

Figure 5 Bagged mulch loaded into an intermodal trailer for shipment.

Employment level in Florida has gradually increased since 1989 from a beginning of 20 to 30 to a present level of 105 to 120. The primary shipping season is from January through June, however the plant operates year round by using the summer and fall months to manufacture and stockpile product at the plant and at eighteen locations throughout the market area which will be shipped to customers in the spring. The plant is presently operating at maximum capacity for the facilities with three shifts per day for six days per week.

Mulch Manufacturing has been successful in establishing a firm position in the market with a diversified customer base of over 3,000 that range from single load customers to the largest merchandisers in the country who purchase thousands of loads per year. We have established a reputation for quality products and excellent customer service. The opportunity for expansion is unlimited and is restricted only by the size of our facilities.

# OPPORTUNITIES

The opportunities for growth are nearly unlimited due to the popularity of Lawn & Garden products which is an \$85 Billion market segment and is one of the fastest growing industries due to the popularity of home gardening. Mulch Manufacturing will grow as the industry grows and as we continue to capture more of the market share.

In order to capitalize upon this opportunity it is essential that we are able to position the company so that it can meet the demands of a growing industry. The primary requirements to successfully meet these demands are:

1. Raw material availability
2. Expansion of product line
3. Company facilities

## STRUCTURING TO MEET THE OPPORTUNITY

### Raw Materials

Mulch Manufacturing currently purchases approximately \$3 million in raw materials each year from local businesses and vendors. This will increase with the planned additions. The addition of the sawmill in 1998 has greatly increased the potential to economically use the Cypress resources which are available. This makes it possible to harvest the higher value fiber in the core of the logs as lumber which has much more worth and then use the scrap slabs, but cuts, tops and bark as mulch. This process fully utilizes 100% of the raw materials producing no scrap for disposal. In order to feed this process it is necessary to obtain reliable suppliers of Cypress logs suitable for sawing. As the demand for this type of timber increases due to local demands from Cypress sawmills and the availability of saw quality Cypress timber declines in this area, it becomes necessary to bring logs in from other areas. Additionally, Cypress log availability in any given area can be hampered by local weather conditions or market constraints which could have devastating consequences if alternate sources were not available. It is, therefore, necessary to have the capability to import saw quality Cypress logs from other areas such as Louisiana, Alabama, Mississippi, Georgia, South Carolina, etc.. Due to the high cost of transporting by over the road trucks, the only economical method to import these logs is by rail. This makes it necessary for the facility to have rail access.

## Expansion of Product Lines

Due to the high volume of raw materials being processed it is appropriate that additional products be produced which will optimize the utilization of the resources being consumed. For instance, it is a waste of resources and a loss of profitability to use high quality saw logs to make mulch when a higher value product such as lumber could be produced. Additional products which can be produced with only minimal additional capital investment include fencing, playground materials, building materials, log home materials as well as additional landscaping products such as timbers and mulch. The partner company which are planning to join our facility includes a company that produces Cypress fencing and is using raw materials produced by our sawmill. This will greatly decrease their freight costs by locating where their raw materials are produced. The second company considering locating here is a log home manufacturer who will purchase milled Cypress logs and put log home kits together on site rather than transporting them to their own site.

## Company Facilities

In order to produce the additional products and respond to the increased demand for our existing products, it is essential that we upgrade our facilities to make it possible to produce the type of products at the volumes required to satisfactorily address the available market. The primary facilities required can be defined in three categories:

### 1. Additional real estate

The current facility located five miles south of Callahan, Florida on route 301 is approximately 40 acres. However, half of this site is unusable due to accessibility or wetlands conditions. All available space is fully utilized and additional space has been leased in Jacksonville for our use. It is essential that additional operating space be obtained for expansion of the current operation and the addition of production facilities, raw material storage, finished goods storage, parking and the incorporation of additional business operations. The most logical, and probably the only alternative to expand the present facilities, is the acreage presently owned by ITT Rayonier located adjacent to our present plant to the North between the CSX railroad and highway 301 (see figures 1 and 2 attached). Even though some of this property is also wetlands, sufficient dry area is available to accommodate our needs. Utilization of this property would entail clearing and prepping, stabilizing, connecting the current plant to the new area with a driveway through the wetland and installing a rail spur. This property would also be used by other businesses who have demonstrated a desire to locate near our present plant to minimize transportation and operational costs.

### 2. Rail accessibility

Rail access is essential for the purpose of importing raw materials, primarily cypress logs, from other locations. These materials would be purchased in other

states where availability and cost are acceptable and transported to the Florida plant for processing. The rail would also be used to transport logs from Florida to our other plant in Ohio for processing into mulch or to transport finished goods produced by Mulch Manufacturing or partner companies to market. This rail access is essential for the current operation to remain viable in the long run and for any expansion. CSX has performed a feasibility study and has concluded that a rail spur could be constructed on the target property.



Figure 6 CSX main rail track along the Northwestern border of the property looking North showing the new property on the right.

### 3. Equipment

Most of the equipment required for the expanded operation is presently on hand and is being used in the present operation. Some modifications, upgrades and additions will be required for the expanded operation such as milling equipment for log home cants, equipment to recover long slabs and equipment to produce fencing products. This equipment has been identified and is presently available off the shelf. The cost is minimal compared to the cost of the equipment already in place. Some of this equipment will be provided by partner companies which will operate on the site as separate companies.

## EMPLOYMENT CONSIDERATIONS

The expansion under consideration by Mulch Manufacturing will make additional jobs available with Mulch Manufacturing as well as with the other companies which will operate in conjunction with the expanded facility and will provide a base for employment by supporting organizations both on site and off site. The present payroll at this facility exceeds \$3 Million per year excluding benefits. This employee population includes unskilled, semi-skilled, equipment operators, clerical, supervision and corporate management. The average hourly wage including the entire employee base is approximately \$13.24 per hour plus benefits. The benefits provided to the employees include medical, paid vacation, paid sick leave, life insurance and holiday pay. All of the employees employed by Mulch Manufacturing are full time year round employees.

It is anticipated that after the first year of operation with the improved facility the payroll will exceed \$5 Million per year. The total economic benefit to the local community will exceed \$15 Million per year after the improvements are in place and full operation is underway. Anticipated resulting employment levels are shown in the chart on the following page:

## Budgeted Employment Level

	Mulch Manufacturing Operations	Partner Company Operations	Local Outside Contractors
Present employment level	110		
During Construction	125	20	15
First year of operation	140	25	10
Years 2 - 5	150	30	10
Years 5 - 10	170	40	15

Table 1 - Anticipated employment levels resulting from the expanded operation at the Mulch Manufacturing facility in Nassau County Florida.

## ALTERNATE PLAN

Mulch Manufacturing has been an integral part of the Nassau County community for over twelve years. A substantial investment has been made in this facility and we have enjoyed our relationship with the local community. It is our preference to remain in our present facility and make the required improvements to facilitate the expansions necessary to address the opportunity we presently have. We have three ways in which we can proceed:

1. Expand the present facility as required to meet the objectives.
2. Leave the present facility as it now exists without expansion and construct an additional facility in another location.
3. Move the present facility to a new location where the required facilities are in place or can be constructed at minimum cost.

Creating a new facility at an alternate site where raw materials are more plentiful and where the political environment is conducive to new business locations is a viable alternative to the expansion of the present facilities. Our search for alternate sites has resulted in several potential locations where facilities are available, raw materials are plentiful and economic help is available from the local municipalities. Such a move would be disruptive to the business and would result in a higher initial investment. However, the transportation savings which will result from being located closer to the

source of raw materials would be beneficial and would result in substantial cost savings over the long term.

The preferred plan is to expand the present facility to incorporate our needs as well as the opportunity to provide facilities for additional partner companies. This action would also provide additional employment for the local community and a collateral benefit to the economy of the county.

## **ASSISTANCE REQUIRED**

When Mulch Manufacturing moved into Nassau county twelve years ago we purchased property and installed a mulch operation which consisted of property improvements and the installation of production equipment. This expenditure was approximately \$2.5 million. In 1996 we upgraded the production facility with automation and other improvements at a cost of over \$1.0 million. In 1998 we installed the sawmill at a cost of approximately \$1.5 million and then spent an additional \$1.0 million last year to upgrade it for increased capacity. In fact, the total investment that has been made in the Nassau county facility is in excess of \$8 million. We have also paid a total of approximately a quarter of a million dollars in property taxes. This was all accomplished strictly with company funds. We have not receive, nor have we requested, any type of financial assistance or tax abatements from the state or local municipalities during our entire tenure in the county.

The situation has now changed and we can no longer make this type of expenditures without some form of assistance or consideration. With our track record, employment needs and financial contributions to the local economy the opportunities available in many locations for land use, grants, tax abatements, low interest loans and other incentives are plentiful.

Our desire is to remain in Nassau county and expand our present facilities to accommodate our needs and provide an attractive opportunity for partner companies to locate adjacent to our plant.

To make this expansion feasible we must be able to obtain some economic assistance from the local community in the form of a grant which could finance the rail spur installation on the new property and/or providing the land to us at no cost for the expansion as well as other economic or tax abatement incentives which might be available.



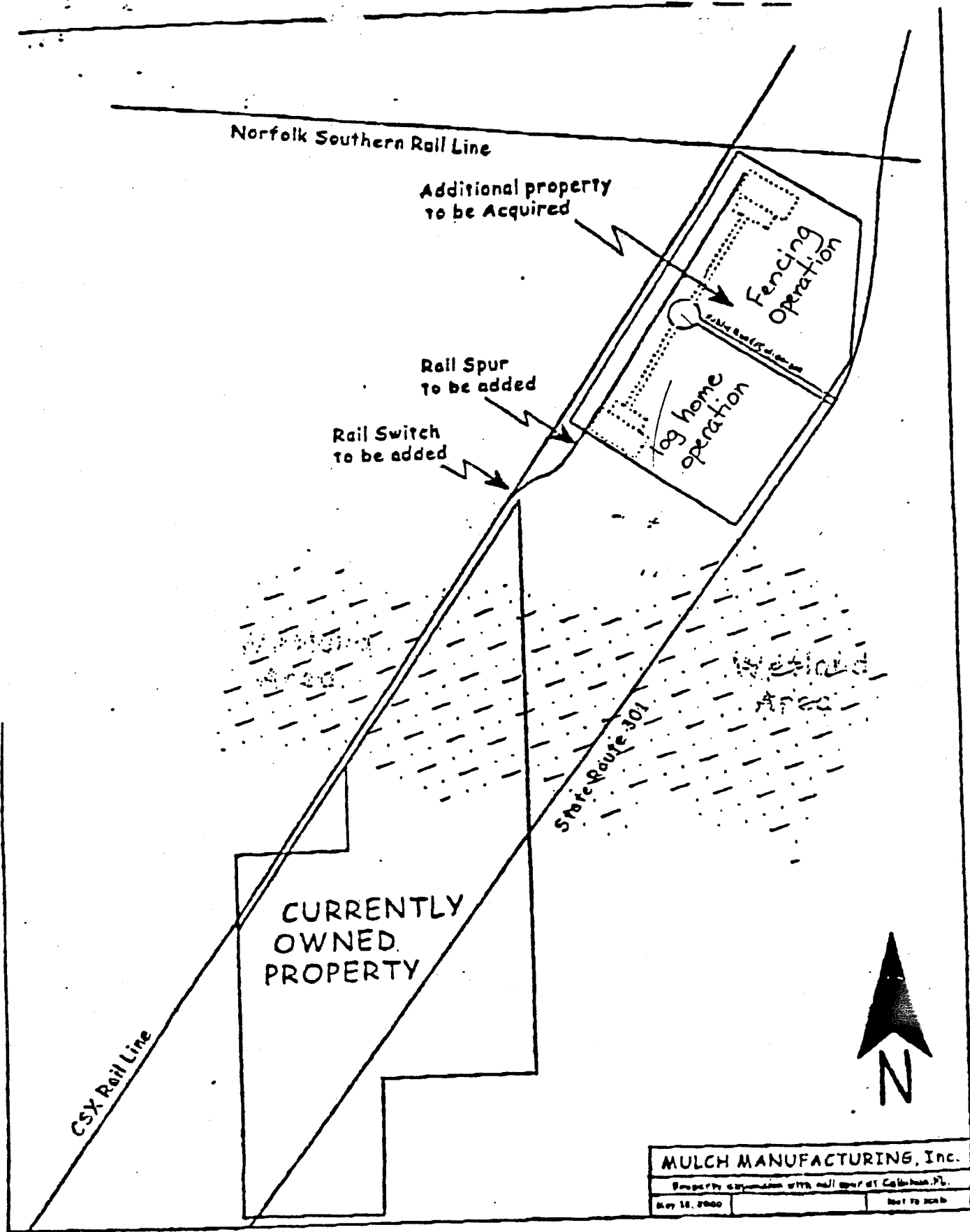

**MULCH MANUFACTURING, Inc.**  
 Property acquisition with rail spur at Calhoun, Pa.  
 May 18, 2000

Not to scale

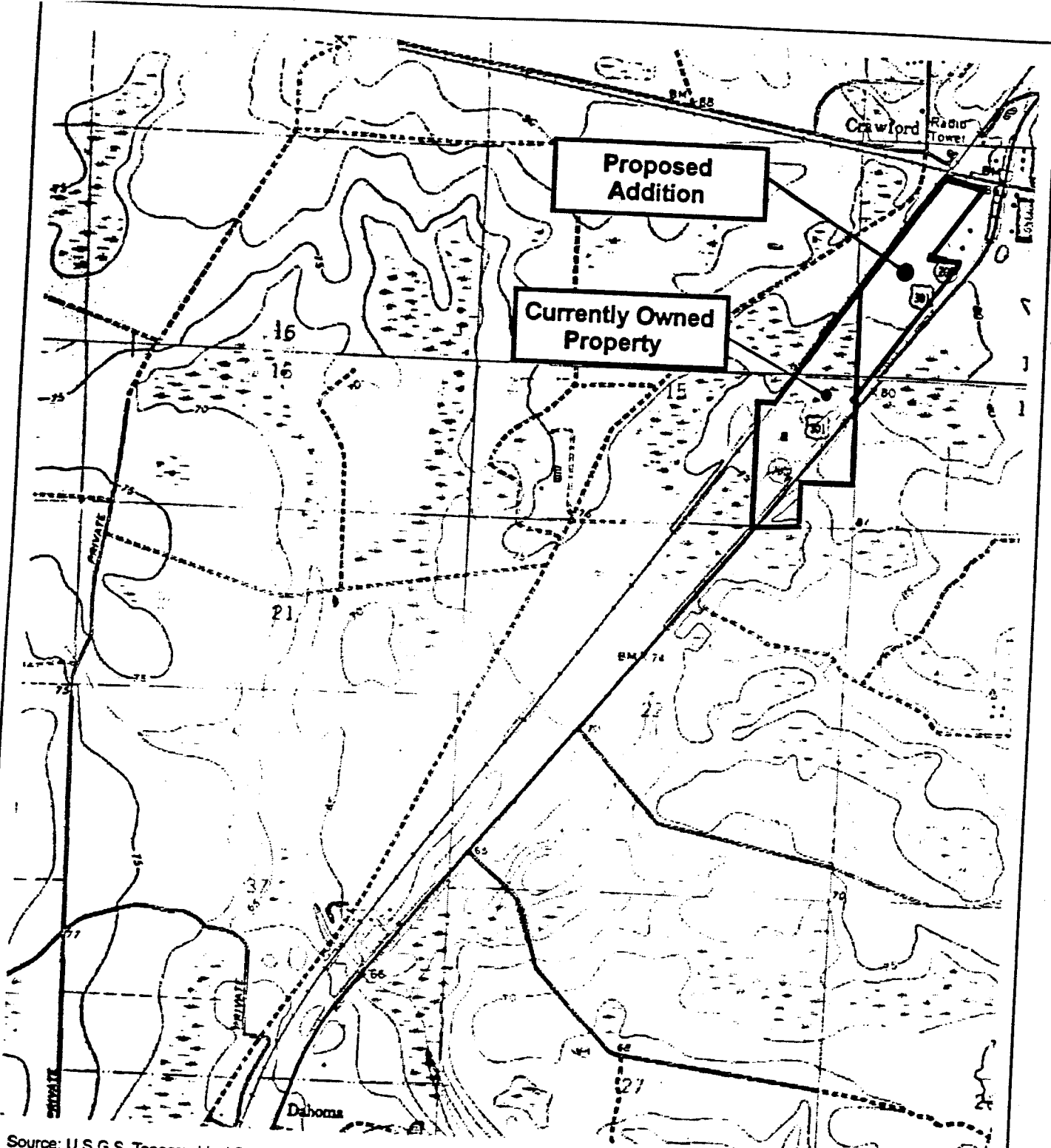

Source: U.S.G.S. Topographical Survey, Bryceville and Hilliard SW, Fl., Quadrangles (1992)  
 Scale: 1"=2000'



Location/Topographic Map

Mulch Manufacturing, Inc.  
 U.S. Highway 301 South  
 Callahan, Florida

Figure No. 1

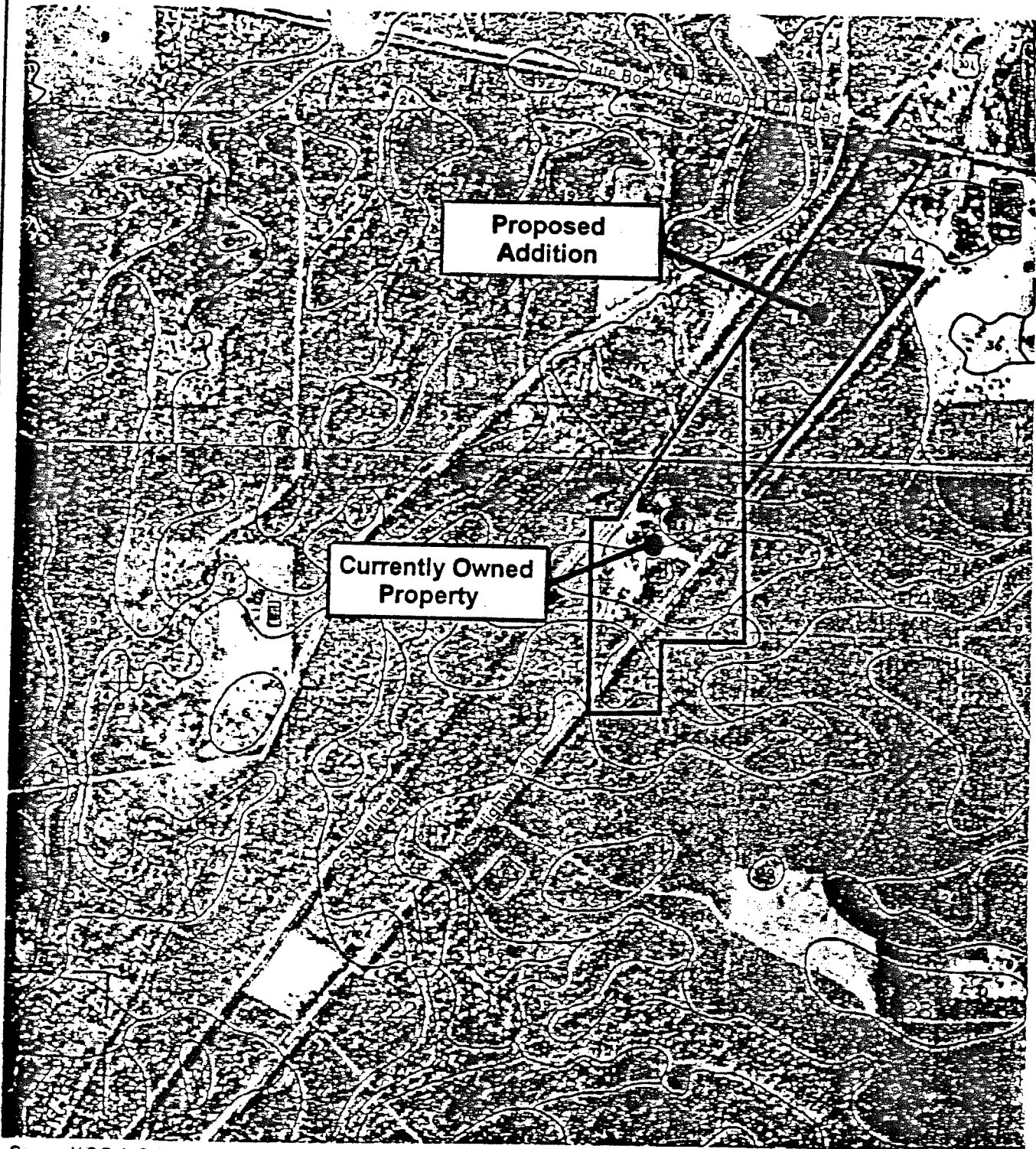

Source: U.S.D.A. Soils Survey for Nassau County, Florida  
 Scale: 1"=1666'

- 9 - Leon fine sand
- 18 - Lynn Haven-Wessconnett-Leon complex, depressional
- 24 - Kings Ferry fine sand
- 36 - Boulogne fine sand
- 39 - Evergreen-Leon mucks, depressional



Soils Map

Mulch Manufacturing, Inc.  
 U.S. Highway 301 South  
 Callahan, Florida

Figure No. 2



JEB BUSH  
GOVERNOR

STATE OF FLORIDA

# Office of the Governor

THE CAPITOL  
TALLAHASSEE, FLORIDA 32399-0001

[www.flgov.com](http://www.flgov.com)  
850-488-7146  
850-487-0801 fax

October 4, 2001

Mr. J.M. "Chip" Oxley, Jr.  
Ex-Officio Clerk  
Nassau County  
Post Office Box 1010  
Fernandino Beach, Florida 32035-1010

Dear Mr. Oxley, Jr.:

**RE: EDTF Project #00/0145A on behalf of Mulch Manufacturing, Inc.**

Enclosed is the original fully executed Contract Amendment Number 2 under the Economic Development Transportation Fund (EDTF) on behalf of the project and company stated above.

Continued success. If you have any questions, please contact me via phone, 850/922-8733; fax, 850/487-3014; or e-mail, [greenwv@eog.state.fl.us](mailto:greenwv@eog.state.fl.us).

Sincerely,

A handwritten signature in cursive script that reads "Vera A. Greenwood".

Vera A. Greenwood  
Incentives Coordinator  
Office of Tourism, Trade, and Economic Development

/vag

Enclosure



Governor's Mentoring Initiative  
BE A MENTOR. BE A BIG HELP.  
1-800-825-3786